

PROGRAM

SHO 2019

15th and 16th April International Symposium on
Occupational Safety
and Hygiene



University of Minho

sposho@sposho.pt



Guimarães Portugal

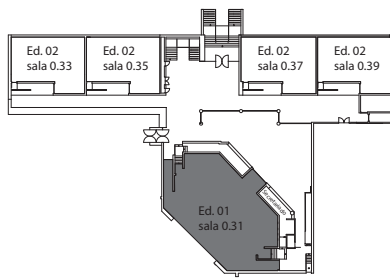

sala 0.31

08:30 REGISTRATION

10:30 Coffee-break

12:15 Lunch

14:00 OPENING SESSION

14:30 Round Table - "I&D em Segurança e Saúde Ocupacionais na relação Universidade - Empresa"
Chair: Pedro Arezes

15:30 O Sistema da Indústria Responsável e os Desafios da Agenda 2030 - Objetivos de Desenvolvimento Sustentável das Nações Unidas
António Oliveira, IAPMEI
Chair: Sérgio Miguel

16:00 Coffee-break / posters presentation

Ergonomics & Human Factors - Chair: Pedro Arezes

16:30 Quantifying the Qualitative: Defining Measures of Human Performance Using Wearable Sensors
Leia Stirling, MIT Human Systems Lab, USA

17:00 Postural instability during obstacle crossing while performing manual material construction handling tasks
Rui Azevedo, Eduardo Abade, Nuno Teixeira, Alberto Carvalho and Maria Sá

17:15 Postural evaluation by multiple complementary methods to obtain better results in the prevention of occupational risks
Thais Helena de Lima Nunes

17:30 An experimental analysis of ergonomics in an assembly line in a Portuguese automotive industry
Mariana Rodrigues, Isabel Loureiro, and Celina Leão

17:45 Correlation between Manual Lifting of Loads and Low Back Pain in Workers of a Supply Center of Vegetables and Fruits
Luciano Fernandes Monteiro, José Wendel dos Santos, Edmara Thays Neres Menezes, Veruschka Vieira Franca, Cleiton Rodrigues de Vasconcelos, José Welton dos Santos, Odelsia Leonor Sánchez de Alsina and Acácia Lima Silva

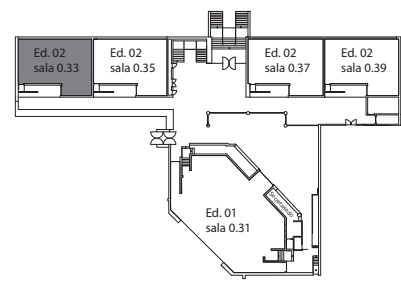

sala 0.33

10:00 COURSE - “How to submit a good paper to Safety Science”
George Boustras, Editor of Safety Science, Elsevier

12:15 Lunch

16:00 Coffee-break / posters presentation

➔ **SESSION B1.1: CONSTRUCTION SAFETY**
 Chair: Fernanda Rodrigues

16:30 Occupational safety and health in Solar Home Systems (SHS) by Brazilian standards
José Alberto Barroso Castañón, Matheus Pereira Mendes and Roberta Paulina Tertolino da Silva

16:45 Risk Management and Supply Chain Risk Management Procedures in Construction Companies
Mohammad Shahriari

17:00 Safety management plan for equipment used in working at heights
Sybelle Maria Santana Leite Bastos, Bianca M. Vasconcelos, Suellem Attila Parisi, Tomi Zlatar and Beda Barkokebas Junior

17:15 Sustainable Safety Measures applied in Construction
Cristina Reis, Eliana Carpinteiro, Paula Braga, Luis Filipe Sanches Fernandes and Carlos Oliveira

17:30 Contribution Evaluation of “Branco Micaela” granite used in facades, for the safety of workers
Paula Braga, João Gonçalves, Carlos Oliveira, José Correia, José Ferreira and Cristina Reis

17:45 Safety in Urban Rehabilitation Works of drainage networks
Cristina Reis, Paula Braga, Luis Filipe Sanches Fernandes and Carlos Oliveira

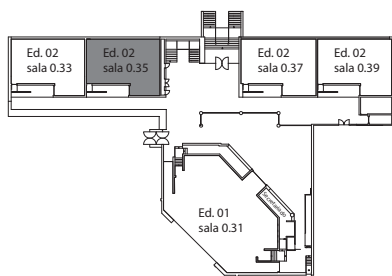

sala 0.35

09:00 COURSE - Considerações sobre a Norma ISO 45001:2018
Eng^o João Costa, ONS/ISQ, PT

10:30 Coffee-break

10:45 COURSE - A Norma ISO 45001:2018 na óptica do processo de certificação
Eng.º Nuno Lourinho, SGS PT

12:15 Lunch

16:00 Coffee-break / posters presentation

➔ **SESSION B1.2: CHEMICAL / BIOLOGICAL AGENTS**
 Chair: Carla Viegas

16:30 Is the quantitative cut-off a suitable surrogate to ensure a good indoor air quality regarding the mycobiota in health care facilities?
Carla Viegas and Beatriz Almeida

16:45 Barbecue grill workers occupational exposure to particulate-bound polycyclic aromatic hydrocarbons
Marta Oliveira, Sílvia Capelas, Cristina Delerue-Matos, Isabel Brás Pereira and Simone Morais

17:00 Dust, radon and radiation exposure in environmental remediation works of old mine sites
Fernando P. Carvalho, João Oliveira and Margarida Malta

17:15 Study on the emission of nanoparticles from metal cleaning operations using laser technologies
Helder Esteves, João Gomes, Rosa Miranda, Paula Albuquerque, Mar Viana and Germán de la Fuente

17:30 Avaliação qualitativa do risco químico em laboratório
João Almeida, João Paulo Figueiredo, Ana Ferreira, Francisco Silva and Anabela Morgado

17:45 Escola de Saúde e Segurança VLI - Visão Estratégica na Implantação da Gestão de Riscos Corporativos e Operacionais de uma Corporação
Vívian de Sousa Valente, Nelson Ricardo Moraes Pereira e Silva, Glauce Batista Lima, João Gabriel Souza de Miranda, Jordana Ferreira Lopes Lanzotti and Gustavo Mucci Oliveira

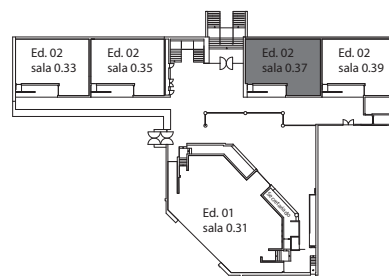

sala 0.37

09:00 **COURSE Part 1 - Segurança contra incêndios**
Eng^o Miguel Gonçalves, FEUP, PT

10:30 Coffee-break

10:45 **COURSE Part 2 - Segurança contra incêndios**
Eng^o Miguel Gonçalves, FEUP, PT

12:15 Lunch

16:00 Coffee-break / posters presentation

➔ **SESSION B1.3: SAFETY MANAGEMENT**
Chair: Matilde Rodrigues

16:30 **The Importance of Emergency Response Training: A Case Study**
Ana Sofia Pinheiro, Rui Gouveia, Ângelo Jesus, Joana Santos and João Santos Baptista

16:45 **How to prevent the risk of slipping in kitchens? - A short review**
Raquel Martins, J. Duarte and António Torres Marques

17:00 **Comparison of workplace accidents between Spain and Portugal in the fishing sector: impact of musculoskeletal disorders in the 2008-2014 period**
Alberto Villarroya López and Jose María Rivas Moar

17:15 **Risk assessment in the open pit mining industry- a short review**
Jacqueline Castelo Branco, Rania Rebbah, J. Duarte and João Santos Baptista

17:30 **Occupational accidents in the mining industry - a short review**
J. Duarte, J. Santos Baptista and A. Torres Marques

17:45 **A brief overview of the use of collaborative robots in industry 4.0: human role and safety**
Sara Bragança, Eric Costa, Ignacio Castellucci and Pedro Arezes

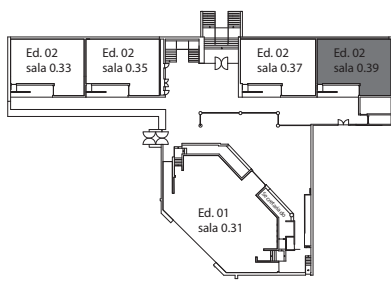

sala 0.39

09:00 COURSE - Case studies

1. Confined spaces - latent hazards and risks

Eng^a Ana Pires, FEUP, PT

2. Safety planning and temporary structures

Eng^o Arnaldo Reis, Brisa Gestão de Infraestruturas S.A., PT

3. Safety management in the large metal structures removal

Eng^a Andreia Silva, Ramalho Rosa Cobetar, Sociedade de Construções S.A., PT

12:15 Lunch

16:00 Coffee-break / posters presentation

➔ SESSION B1.4: ERGONOMICS (in Portuguese)

Chair: José Carvalhais

16:30 Low-Back Pain (LBP), Work and Absenteeism: a follow-up study

Florentino Serranheira, Mafalda Sousa-Uva, Francisco Heranz, Francisco Kovacs, António Sousa-Uva and Ema Sacadura-Leite

16:45 Influência do frio extremo na temperatura interna corporal, na pressão arterial sanguínea e frequência cardíaca

Joaquim Oliveira, João Cardoso, Tomi Zlatar, Denisse Bustos, J. C. C. Guedes, José Torres Costa and J. Santos Baptista

17:00 Comparative Study between Ergonomics Evaluation Methods in Waste Sorting Stations

Jorge Cunha and Paula Carneiro

17:15 Applied ergonomics using Corlett and Manenica method analysing the working conditions of brazilian physical therapist in private practice

Paula Frambach Murtinho, Justino Sanson Nobrega, Dan Abensur Gandelman, Izabel Cristina Correa Saldanha and Antonio Carlos Sarquis

17:30 Influence of the use of exoskeletons on workers' physical and psychophysical loading - a literature review

João André Cardoso, Ana Colim, Nuno Sousa and Pedro Arezes

17:45 Influência da exposição ao frio extremo na temperatura interna corporal e na temperatura da pele

João Cardoso, Joaquim Oliveira, Tomi Zlatar, Denisse Bustos, J. C. C. Guedes, José Torres Costa and J. Santos Baptista

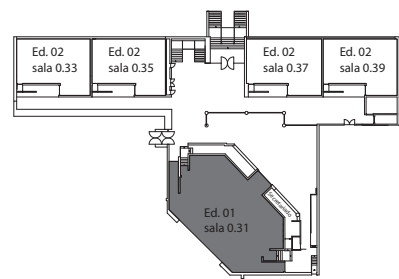

sala 0.31

Safety Management I - Chair: Nélson Costa

- 09:00** Occupation safety in automated environments: needs and consequences
António B. Moniz, Faculty of Sciences and Technology of University NOVA Lisbon, PT
- 09:30** Revisiting diffusion models: Portuguese integrated management systems evolution
Mónica Cabecinhas, José Pedro Domingues, Paulo Sampaio and Pedro M. Arezes
- 09:45** Work-related accidents in urban solid waste collection
Nailson Diniz, Pamela Castro, Eliane Lago, Felipe Mendes da Cruz, Tomi Zlatar, Daniel Wasnievski, Alexandre Pereira and Beda Barkokebas Junior
- 10:00** Assessment of airborne nanoparticles emissions in the ceramic industry
Helder Esteves, João Gomes, Rosa Miranda and Paula Albuquerque
- 10:15** Transport Regulations and Occupational Safety and Health in the Supply Chain of Chemicals
Christian Felten and Thomas Köhler
- 10:30** Coffee-break / posters presentation

Safety Management II - Chair: J. Santos Baptista

- 11:00** On the interface of safety and security
George Boustras, Dean of the Ioannis Gregoriou School of Business Administration, Cyprus
- 11:30** Safety management in the maintenance works on motorways through DELPHI methodology and Pareto's concepts
José Silva and Carlos Rodrigues
- 11:45** Effectiveness of occupational safety and health training methods: a study with metalworking small enterprises
Beatriz L. Barros, Artemisa R. Dores and Matilde A. Rodrigues
- 12:00** Assessment and Improvement Opportunities for Occupational Health and Safety in the Portuguese Food Processing Industry
Mariana R. Lourenço, Tânia M. Lima, Pedro D. Gaspar and Fernando Charrua-Santos
- 12:15** (Post) academic safety and health courses, how to assess quality?
Paul Swuste and Frank van Dijk
- 12:30** Lunch

Industrial Ergonomics - Chair: Rui Melo

- 14:15** Workload Measures—Recent Trends in the Driving Context
Nélson Costa, ALGORITMI Research Center, School of Engineering, University of Minho, PT
- 14:45** Thermal analysis of musculoskeletal overload in vertical handling of loads in an heterogeneous sample
Irina Bezerra, Ana Colim, Pedro Arezes and Ricardo Vardasca
- 15:00** The Influence of Health Perception on the Work Ability Index Among Municipal Workers in 2015 and 2017
Camila Ribeiro, Teresa Cotrim, Vitor Reis, Maria João Guerreiro, Ana Sofia Janicas, Suzana Maria Candeias and Maria Margarida Costa
- 15:15** Burnout and musculoskeletal pain: a health promotion intervention
Ana Paula Amaral and Gustavo Santos
- 15:30** Ageing at Work: Capacity for the Work of Estesc Teachers
Tânia Correia, Helder Simões, João Figueiredo, Ana Ferreira, Emília Telo, Joaquim Pereira and Teresa Cotrim
- 15:45** Coffee-break

Occupational Safety and Hygiene - Chair: Sérgio Miguel

- 16:15** Development of OSH - a common challenge for managers, workers and OSH-professionals
Anders Kabel, President of AM-PRO, Denmark

16:45 CLOSING SESSION

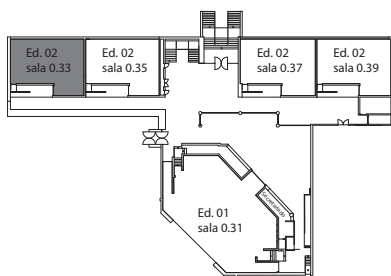

sala 0.33

➔ SESSION B2.1: PSYCHOSSOCIAL RISKS - Chair: Catarina Silva

- 09:00** Stress and work engagement in health professionals
Liliana Fontes, Alice Gonçalves, A. Rui Gomes and Clara Simões
- 09:15** Stress and burnout in health professionals
Alice Gonçalves, Liliana Fontes, Clara Simões and A. Rui Gomes
- 09:30** Psychosocial risks factors among psychologists: what are we talking about?
Carla Barros, Pilar Baylina, Carla Fonte and Sónia Alves
- 09:45** The prevalence of Burnout in Portuguese physiotherapists
Adérito Seixas, Teresa Marques, Isabel Moreira da Silva, Joana Azevedo and Sandra Rodrigues
- 10:00** Psychosocial risks assessment of the teachers in the University of Labour Relations in A Coruña (ERLAC) with the method FPSICO 4.0
Rut Martínez Sánchez, Rubén Rodríguez Lista and David Vispalia Lage
- 10:15** Dangerous and precarious work and the high cost of emotional demands controlled by alcohol: a systematic review
Gina Marins, Liliana Cunha and Lacomblez Marianne
- 10:30** Coffee-break / posters presentation

➔ SESSION B3.1: OCCUPATIONAL HYGIENE - Chair: M. Luísa Matos

- 11:00** Applicability of Heat Stress Index in the Context of Military Work: Pilot Study
Jessyca Galan and Joana Guedes
- 11:15** A comparison of ISO 2631-5:2004 and ISO 2631-5:2018 standards for whole-body vibrations exposure: a case study
M. L. De la Hoz-Torres, A. J. Aguilar-Aguilera, M. D. Martínez-Aires and Diego P. Ruiz
- 11:30** Analysis of Acoustic and Luminic Comfort in a Marble and Granite Processing Company in Campina Grande-PB
Jaqueline Silva, Maria Betânia Santos, Ronildo Oliveira Neto and Fabiano Santos
- 11:45** Occupational hygiene in slave work as a potential indicator for typifying the neo-slavery
Gairo Garreto, J. Santos Baptista, Antônia Mota and A. Torres Marques
- 12:00** Influence of severe cold thermal environment on thermal sensation and physiological responses
Tomi Zlatar, Joaquim Fernando Correia de Oliveira, João António Pereira Cardoso, Lidia Denisse Bustos Sandoval, Joana Cristina Cardoso Guedes and João Manuel Abreu dos Santos Baptista
- 12:30** Lunch

➔ SESSION B4.1: SAFETY MANAGEMENT - Chair: José Pedro Domingues

- 14:15** Indoor Air Quality in Hospitals: How is the situation in Portugal?
Mariana Farraia, Inês Paciência, Ana Isabel Ribeiro, André Moreira and João Cavaleiro Rufo
- 14:30** Relation between vibration/noise with the type of surface, in light vehicles. Use of data as a tool to study the health impact of drivers
Marco Dias and Luísa Matos
- 14:45** Occupational accidents in Brazil and Portugal: a comparative study
Daniele Costa, Bruna Faustino, Victor Esteves and Claudia Morgado
- 15:00** Analysing and Classifying Risks: a Case-Study in the Furniture Industry
Celina P. Leão, Matilde A. Rodrigues and Irene Brito
- 15:15** The effect of prolonged sitting on students
Hamou Boudrifa, Sabrina Slimani, Ouiza Oubrahem and Mohamed Ghachi
- 15:30** Perigo Aviário: colisões envolvendo aves e aeronaves no Brasil
Luiz de Paula, Marcelo Nobrega, Luiza Molnar and Patricia Pimentel
- 15:45** Coffee-break

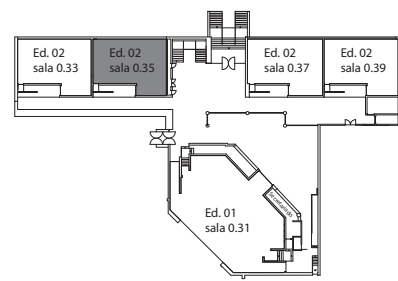

sala 0.35

→ SESSION B2.2: ERGONOMICS - Chair: Sara Bragança

- 09:00** Virtual reality applications in the extractive industry - a short review
J. Duarte, M. Lurdes Dinis and J. Santos Baptista
- 09:15** From conceptual map to the construction of a character to disseminate inclusion of visually impaired people into University Libraries
Erilze Britto, Mônica Uchôa Cavalcanti and Laura Martins
- 09:30** Effects of noise frequency on performance and well-being
Jorge Sousa, Raquel Monteiro, David Tomé and Matilde Rodrigues
- 09:45** Wayfinding of people with disability and reduced mobility in the urban space
Raphael Souza and Laura Martins
- 10:00** Integration of ergonomics in the study of catenary execution projects
Francisco Salguero-Caparrós, María M. Rojas, Maria Del Carmen P. Ferreira and Juan Carlos Rubio Romero
- 10:15** Prevalência de Acidentes de Trabalho na Indústria Cerâmica - Estudo de Caso (portuguese)
Fernando Moreira, Ana Ferreira, João Paulo Figueiredo and Chloé Delassossais
- 10:30** Coffee-break / posters presentation

→ SESSION B3.2: SAFETY MANAGEMENT - Chair: M. Antónia Gonçalves

- 11:00** A pilot study on Energy Expenditure Estimation through Decision Modelling
Lidia Denisse Bustos Sandoval, Alberto Pezzi Sposito, Andre Duarte Lucena and J. C. Guedes
- 11:15** Evaluation of Whole-Body Vibration in Automobile on Routine Travel-A Case Study
Ahmet Meram and Mohammad Shahriari
- 11:30** Safety Stream Mapping - A new tool applied to the textile company as a case study
Inês Gonçalves, José Carlos Sá, Gilberto Santos and Maria Antónia Gonçalves
- 11:45** Risk Management in Personal Transfer Activities using Aerial Baskets and Surfer Boats in Offshore Units
Ronildo Neto, Maria Betania Santos, Thais Rodrigues, João Gabriel Santos Martins and Lorena Mirela Ricci
- 12:00** Reliability of forearm skin thermal assessment during handgrip exercise
Carolina Magalhaes, Pedro Silva, Ricardo Vardasca, Paulo Abreu, Joaquim Mendes and Maria T. Restivo
- 12:15** Risco Tecnológico Inverso para Empreendimentos Residenciais em Zonas Industriais - Um Estudo de Caso
Luiza Molnar, Marcelo Nobrega, Patricia Pimentel and Luiz de Paula
- 12:30** Lunch

→ SESSION B4.2: OCCUPATIONAL HEALTH - Chair: Ana Colim

- 14:15** A Comparative Study between Human Development Index and HSE Standards among Portugal, Angola, Mozambique, Croatia, Italy and Brazil
Nuno Oliveira, Sérgio Duarte, Nelson Sá, Nuno Amaral and Filipa Vogado
- 14:30** Analysis of Industry 4.0 technologies applied to the health sector
Franco da Silveira, Italo Neto, Filipe Machado, Marcelo Pereira Da Silva and Fernando Gonçalves Amaral
- 14:45** Real Time Fatigue Assessment: A short review evidencing the usage of safety monitoring systems with military enforcement
Denisse Bustos, J. C. Guedes, Raul Sousa Pinto, Filipe Conceição, Mário A. Pires Vaz and José Costa
- 15:00** Real Time Fatigue Assessment: A short review evidencing the relevance of physiological monitoring
Denisse Bustos, J. C. Guedes, J. Santos Baptista, Luis Pereira, Mário Vaz and José Torres Costa
- 15:15** Real Time Fatigue Assessment: Identification and continuous tracing of fatigue using a physiological assessment algorithm
Denisse Bustos, J. C. Guedes, Mário Álvares, J. Santos Baptista, Mário Vaz and José Torres Costa
- 15:30** Prevalence of musculoskeletal symptoms in blue-collar workers: association with gender and physical activity level
Isabel Moreira da Silva, Joana Azevedo, Sandra Rodrigues, Adérito Seixas and Jorge Mota
- 15:45** Coffee-break

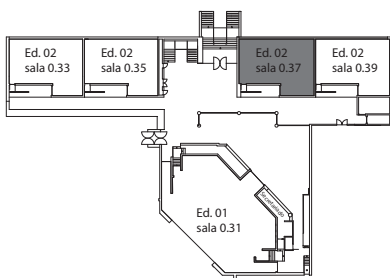

sala 0.37

→ SESSION B2.3: CHEMICAL / BIOLOGICAL AGENTS - Chair: Francisco Silva

- 09:00 Smart carbon fibre reinforced polymer (CFRP) composites with carbon allotropes: A brief reflection on potential safety and health issues
Susana Patrícia Bastos Sousa, Raquel M. Santos and Nuno Rocha
- 09:15 Sampling with passive methods - An added value for the exposure assessment to fungal burden
Beatriz Almeida and Carla Viegas
- 09:30 Risk Assessment of laboratory technicians' exposure to biological and chemical agents
Isabel Brás and Elisabete Silva
- 09:45 Application of Control Banding to Workplace Exposure to Nanomaterials in the Textile Industry
Delfina Gabriela Garrido Ramos, Luis Almeida and Marco Gomes
- 10:00 Assessment of the indoor gamma dose rates in 15 Portuguese thermal spas
Ana Sofia Silva and Maria de Lurdes Dinis
- 10:30 Coffee-break / posters presentation

→ SESSION B3.3: ERGONOMICS - Chair: Teresa Cotrim

- 11:00 People and Ergonomics dimensions in a Lean Methodology: a case study
Laura C. Maia, Anabela C. Alves and Celina P. Leao
- 11:15 Posture analysis of a typist's workstation
Alan Saraiva and Luiz da Silva
- 11:30 ErgoVSM on a hospital pharmaceutical stream
Marcelo Pereira da Silva and Fernando Gonçalves Amaral
- 11:45 Alternative method to predict thermal sensation votes in closed environments
Evandro Eduardo Broday and Antonio Augusto de Paula Xavier
- 12:00 Sintomatologia Músculo-Esquelética Auto-Referida Em Trabalhadores Do Setor Químico-Farmacêutico (pt)
Inês Sousa Santos, Teresa Patrone Cotrim and Cecília Ganilho
- 12:15 Análises Ergonômicas como Ferramentas de Prevenção aos Distúrbios Osteomusculares Relacionados ao Trabalho numa Indústria Metalúrgica Pesada (pt)
Samuel de Moraes
- 12:30 Lunch

→ SESSION B4.3: PSYCHOSOCIAL RISKS - Chair: Carla Barros

- 14:15 Adaptation and Validation of the Work-Family Conflict and Family-Work Conflict Scales in Portuguese Nurses: 10 Item Version
Clara Simões, Scott McIntyre and Teresa McIntyre
- 14:30 Measures for Managing Psychosocial Risks in Vocational Education and Training Organizations
Sari Tappura and Johanna Pulkkinen
- 14:45 Psychological Distress on Nurses: The Role of Personal and Professional Characteristics
Clara Simões and A. Rui Gomes
- 15:00 Proposal of an instrument for the characterization of Complex Socio-Technical Systems: a study of an Emergency Department
Angela Weber Righi, Priscila Wachs and Tarcisio Abreu Saurin
- 15:15 Sustainable business strategies: what you think is what you do?
Eduarda Pereira, Isabel Loureiro, Paulo Ribeiro, Susana Costa, Nelson Costa and Pedro Arezes
- 15:30 Análise dos Riscos Psicossociais na Atividade dos Trabalhadores de uma Indústria Transformadora (pt)
Lúcia Simões Costa and Ângela Ribeiro
- 15:45 Coffee-break

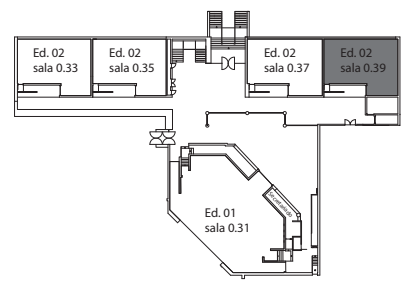

sala 0.39

➔ **SESSION B2.4: SAFETY MANAGEMENT (IN PORTUGUESE) - Chair: Isabel Loureiro**

- 09:00 **Work ability of Health Care Workers in a tertiary hospital: a Portuguese reality**
Marcio Oliveira, Pedro Moura Guedes, Paulo Pinho and Pedro Norton
- 09:15 **Análise da Capacidade de Trabalho em Função das Características Sócio-Demográficas e dos Horários em Operacionais de Água, Saneamento e Resíduos**
Ana Dionísio, Teresa Cotrim and José Carvalhais
- 09:30 **Quadro Regulador da Proteção Radiológica em Portugal e a Exposição a Fontes Radioativas de Origem Natural - o Caso da Exposição ao Radão nos Estabelecimentos Termais**
Ana Sofia Silva and Maria de Lurdes Dinis
- 09:45 **Enfrentar os desafios da informalidade e subnotificação de acidentes de trabalho: a experiência de implementação de um sistema local de monitorização**
Luiz Gonzaga Chiavegato Filho, Danilo de Brito Garcia and Marta Santos
- 10:00 **Escola de Saúde e Segurança VLI - Visão Estratégica na Implantação da Gestão de Riscos Corporativos e Operacionais de uma Corporação**
Rose Leite and Marta Santos
- 10:15 **Plataformas de produção de petróleo e protecção contra radiações**
Fernando P. Carvalho, João Oliveira and Margarida Malta
- 10:30 Coffee-break / posters presentation

➔ **SESSION B3.4: VARIOUS TOPICS (IN PORTUGUESE) - Chair: Paula Carneiro**

- 11:00 **Clima e comportamentos de segurança: O caso do trabalho solitário, em sistemas abastecimento de água e tratamento de águas residuais**
A. Oliveira Sousa, Cátia Sousa, Gabriela Gonçalves and José Zica
- 11:15 **Rotatividade de Trabalhadores: Influência dos Fatores Psicossociais de Risco**
Lúcia Simões Costa and Ana Dias
- 11:30 **Exposição a agentes causadores de doenças respiratórias na construção civil: uma revisão sistemática**
Gercica Macêdo, Tomi Zlatar, Bianca Vasconcelos, Eliane Lago, Felipe Cruz, Ana Martins and Béda Barkokébas Junior
- 11:45 **Análise ergonómica na costura em pé - Estudo preliminar**
Ana Rita Oliveira Cunha and Paulo Oliveira
- 12:00 **Avaliação da Qualidade do Ar Interior num Centro de Dia (Estudo de Caso)**
Ana Ferreira, João Paulo Figueiredo and Patricia Coelho
- 12:15 **Análise de Ruído Ambiental a Luz da Legislação e Suas Controvérsias**
Patricia Pimentel, Marcelo Nobrega, Luiza Molnar and Luiz de Paula
- 12:30 Lunch

➔ **SESSION B4.4: ERGONOMICS / OCCUPATIONAL HEALTH - Chair: Rui Azevedo**

- 14:15 **Influence of Permanent Night Work on Circadian Rhythm of Blood Pressure**
Joaquim Pereira, Ana Alves, Helder Simões and Telmo Pereira
- 14:30 **Comparison of compression stockings in the laboratory and by wear trial**
Maria José Abreu, André Catarino and Franziska Enczmann
- 14:45 **Sickness Absence Trends in a Retail Company in United Kingdom**
Cláudia Nunes and J. Santos Baptista
- 15:00 **Qualitative assessment of lighting conditions in occupational context.**
Patrícia Santos, Ema Leite and Susana Consciência
- 15:15 **The role of the industrial work transformation on the exposure patterns**
Ana Assunção, Sarah Bernardes, Carlos Fужão, Jacqueline Gaspar and Filomena Carnide
- 15:30 **Constrangimentos físicos, hábitos de vida e saúde: reflexões para um envelhecimento sustentável (pt)**
Cláudia Calixto, Catarina Silva and João Camacho
- 15:45 Coffee-break

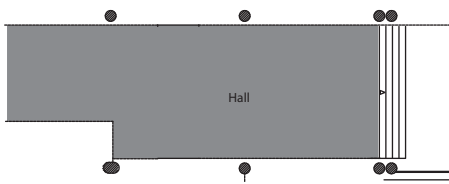

posters

Day 15

- 6**
The relevance of the perception and of the mitigation the risk of flooding on the Tâmega River's waterfront in the city of Amarante
Silvia Gomes and Paulo Oliveira
- 10**
Effects of sunlight on psychological well-being, job satisfaction and confinement perception of workplace: The case of shopkeepers and marketers
Gabriela Gonçalves, António Sousa, Cátia Sousa, Filipa Jesus and Emerança Afonso
- 21**
Manual Materials Handling Case study at a Portuguese Handling Company
Bruna Rosado, Ana Colim and Isabel L. Nunes
- 30**
Collaborative robots and ergonomics
Angelica Reis, Lizandra Vergara, Juliana Teixeira and Franciele Mendes
- 34**
Analysis of indicators for bikeability evaluation in brazilian cites
José Alberto Barroso Castañon, Ludmilla Araújo Barbosa de Castro and Juliana Nazareth de Lana
- 40**
Lighting assessment at workplaces in a granite manufacturing company
Cláudia Santos, Patrícia Ribeiro, Catarina Pereira, Joana Silva, Andreia Torres, Luís Durães, Isac Pinhão, Andreia Araújo, Jéssica Brito, Diogo Vivas, José Pereira, Ana Colim and Paula Carneiro
- 55**
Volatile organic compounds mixtures in hospital environment - The common exposure scenario
Susana Viegas and Margarida Mateus
- 62**
Absenteeism of public workers - Short review
Edison Sampaio and João Baptista
- 67**
Ergonomic assessment and workstation design in a furniture manufacturing industry - A Case Study
Ana Colim, Paula Carneiro, Costa Néilson, Arezes Pedro and Nuno Sousa
- 71**
Towards a private health judicialization: a court processes analysis in Brazil
Luis Fernando Salles Moraes, Dalton Tria Cusciano, Guilherme Koreeda, Diego Fernando Ferreira de Oliveira and Mauro Maia Laruccia
- 80**
Ergonomic assessment of a wire terminal crimping workstation
João André Cardoso, Jorge Faria, Ana Colim and Paula Carneiro
- 81**
Good practices to reduce noise levels in the neonatal intensive care unit
Carlos Carvalhais, Manuela V. Silva, Ana Xavier and Joana Santos
- 85**
The Influence of Active Workstations on Work Performance, Productivity Indicators and Sedentary Time: A Systematic Review
Sofia Ramos, Sara Maheronnaghsh, Carolina Vila-Chã, Mário Vaz and Joana Santos
- 95**
The Virtual Reality in Olive Oil Industry Occupational Health and Safety: an integrative review
Juan Antonio Torrecilla-García, Maria Del Carmen, Pardo-Ferreira, Maria Martínez-Rojas and Juan Carlos Rubio-Romero
- 96**
Trabalho escravo no Brasil colonial e imperial: revisão temática de estudos descritivos
Gairo Oliveira Garreto, J. Santos Baptista and Antônia Mota
- 103**
Comparação de acidentes fatais na Euroregião Galiza-Norte de Portugal
Hadrián Canosa Rodriguez
- 104**
How We Measure and Evaluate Adult Sleep and Insomnia: Summary of Systematic Review of Literature
Ana M. Cerdeira and Mário Vaz
- 105**
Ergonomic analysis of a bending workplace in a metalworking industry
Sílvia Martins, Ana Oliveira, Paula Carneiro and Ana Colim
- 111**
Fatores de motivação para a melhoria da segurança e saúde no trabalho: a percepção de profissionais especializados
Rogério Galvão da Silva, Luis Fernando Salles Moraes, Alcides Barrichello, José Damásio de Aquino, Dalton Tria Cusciano and Diego Fernando Ferreira de Oliveira
- 119**
Segurança do trabalho em canteiros de obra na cidade de Cajazeiras na Paraíba, um exemplo notório
Cinthya Silva, Amanda Silva, Thacyla Nogueira, Gastão Aquino Filho, Austriclinio Wanderley Neto, Cicero Nogueira Neto and Robson Santos
- 121**
Fatores ambientais e acidentes domésticos em idosos: uma revisão sistemática
Túira Maia and Laura Martins

The authors of Posters, should be next to them on Monday between 16:00 and 16:30.

The authors of Posters, should be next to them on Tuesday between 10:30 and 11:00.

122

Avaliação e adequação física de área de prática esportiva na Paraíba, Brasil

Thacyla Milena Plácido Nogueira, Francisco Judivan Celestino de Sousa, Tássia dos Anjos Tenório de Melo, Samuel de Oliveira Lima, Sâmia Morais de Lima and José Hugo Lins de Figueiredo

123

Frigorobô

Juliana S. Teixeira, Angelica Reis, Franciele Mendes and Lizandra Vergara

124

Percepção da qualidade da iluminação e sintomas associados

Ana Dias and Joana Guedes

125

O perfil do Coordenador de Segurança na fase de Projeto e Obra - Estudo da vertente “competências versus aptidões”

João Lopes and Paulo Oliveira

127

Avaliação postural: estudo de caso em uma confeitaria na cidade de João Pessoa

Alan Gurgel Saraiva, Dóris Fernanda Alves Correia da Silva and Luiz Bueno da Silva

132

A methodology to evaluate the content of Health and Safety Plans concerning building with concrete structure

Rubén Martín Antolin, María Martínez-Rojas, María Del Carmen Pardo-Ferreira and Juan Carlos Rubio-Romero

Day 16

135

Projetos Extensionista como base na Disseminação da Segurança em Instalações Elétricas

Caroline Daiane Raduns and Ubiratan de Oliveira Pereira

136

Doenças profissionais causadas por agentes biológicos num centro hospitalar universitário: análise retrospectiva dos últimos catorze anos

Diana França, Ema Sacadura Leite, João Raposo, Gary Morales and Clara Fernandes-Almeida

137

Thermal environment in freight transport - the case of a vehicle without air conditioning

Sílvia Martins, Ana Oliveira, Nathaly Calderon, Jhonnathan Mora, Ana Colim, Susana Costa and Néelson Costa

138

Análise da postura do Médico Dentista sentado num banco ergonómico

Nídia Lopes, Vanessa Silva and Mário Vaz

141

Riscos psicossociais relacionados a queixas de saúde em profissionais de saúde de um centro hospitalar

Gary Navarro Morales, Diana França, Ema Sacadura-Leite and Olena Shapovalova

143

Circuito de encaminhamento de trabalhadores com Problemas Ligados ao Álcool num Município

Carlos Mendes

144

Desenvolvimento de Aplicativo para Monitoramento da Sobrecarga Funcional e Lesões Osteomusculares Relacionadas ao Trabalho

Alex Soares Marreiros Ferraz, Thomas Victor Rodrigues de Oliveira, Giovanni Cordeiro Barroso, Maria Gilvanise de Oliveira Pontes, Cleverson dos Santos Ferreira and Herik Zednik Rodrigues

145

O desempenho psicossocial versus produtivo na indústria têxtil automóvel - Estudo de caso

Ana Rita Oliveira Cunha and Paulo Oliveira

146

Resposta Fisiológica e Atenção Seletiva em Bombeiros: Estudo-Piloto

Tatiana Teixeira, Joana Guedes and Joana Santos

149

Biomarkers of Exposure - An important exposure assessment tool for Occupational Health interventions

Susana Viegas

150

Estudo dos Factores Psicossociais de Risco em Condutores de Máquinas da Marinha Portuguesa
Célia de Sousa

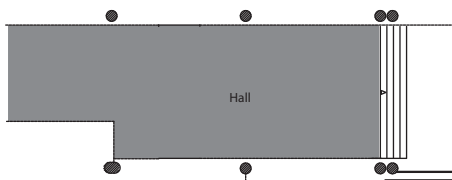

posters

153

Avaliação ergonómica de locais de estudo numa residência universitária - Estudo piloto

Ana Colim, Paula Carneiro, Pedro Arezes and Néelson Costa

154

Ergonomic Analysis of a Fuse Insertion, Press-fit and Test Workstation Using EWA Method - Ergonomic Workplace Analysis

Ana Lúcia Silva, Nuno Sobral, Beatriz Rodrigues, Adriana Gomez, Cláudia Serra, Maria Oliveira, Ivo Pinheiro, Paula Carneiro, Ana Colim, Tiago Pacheco Nuno Bastos, Maria Catarina Mesquita

155

Estudo da influência do conforto térmico na produtividade: uma revisão preliminar

Ana Maria Bueno, Antonio Augusto de Paula Xavier and Evandro Eduardo Broday

157

Bibliometric analysis on the topic of “integrated management systems”: A first glance

Catarina Saraiva, José Pedro Teixeira Domingues, Paulo Sampaio and Pedro Arezes

158

Noise Evaluation in a Workstation of a Furniture Manufacturer Company

Pedro Silva, Miguel Carvalho, Hugo Costa, Gonçalo Dias, João Fernandes, Maria Ferraro, Beatriz Lima Mónica Magalhães, Mariana Martins, Francisco Ramires, Ana Colim and Paula Carneiro

159

Introduction of a mechanical equipment to assist manual handling loads in textile industry - Example of an ergonomic study

Ana Sousa, Paula Carneiro, Ana Colim, Alberto Bumba Carlos Silva, Catarina Barros, Costa Ferreira, João Silva, João Rodrigues, Leandro Barretiri and Pedro Campos

160

Saúde e Segurança no Trabalho: benefícios e dificuldades na implementação de normas internacionais

Silvia Pinto and Renato Boarin

162

Effectiveness of a Job Coaching intervention in the sewing sector of an automobile industry

Inês Diogo, Susana Barata and Sandra Gagulic

163

Noise measurements with different equipments in Waste Management Systems

Liliana Pereira, Miguel Corticeiro, Pedro Carrana and Rui Pais

164

Ergonomic study of workplaces at a textile company

Casimira Lima, Andreia Leite, Ana Ribeiro, Paula Carneiro and Ana Colim

165

Caracterização dos acidentes de trabalho e doenças ocupacionais no Brasil de 2009 a 2015

Carolina Garreto, Ana Sophia Rosado and J. Duarte

The authors of Posters, should be next to them on Tuesday between 10:30 and 11:00.

167

Bibliographic review of the last 10 year-research studies on heart diseases in firefighters (2009-2018)

Alejandro Hurtado Balbuena, Antonio Lopez Arquillos and Juan Carlos Rubio Romero

169

Ergonomic analysis of a manual material handling activity in the food sector

André Roriz, Ana Mendes, Amélia Peixoto, Paula Carneiro and Ana Colim

170

Sintomas relacionados com a exposição a fumos metálicos: Um estudo de caso numa indústria metalomecânica

Pedro Reis, Egar Pinto, Tânia Ferreira and Matilde A. Rodrigues

171

Air quality assessment in schools - quantification of volatile organic compounds

Isabel Brás, Ricardo Almeida, Manuel Pinto and Paulo Pinho

172

Occupational noise exposure assessment - Case study in a weaving

Alexandre Azevedo, Ana Pereira, Cátia Teixeira, Cláudia Campos, Filipe Dantas, Joana Silva, Leonardo Rodrigues, Marta Costa, Rita Pinheiro, Ana Colim and Paula Carneiro

178

Análise das Condições de Trabalho no Porto da Manaus Moderna: O caso dos Carregadores de Bagagens

Jaquelne Silva, Ana Lúcia Silva, Fabiano Santos and Larissa Almeida

181

Acidentes de Trabalho no Município de Ijuí e os Impactos nos Trabalhadores

Caroline Daiane Raduns and Camila Mastella

Room's map

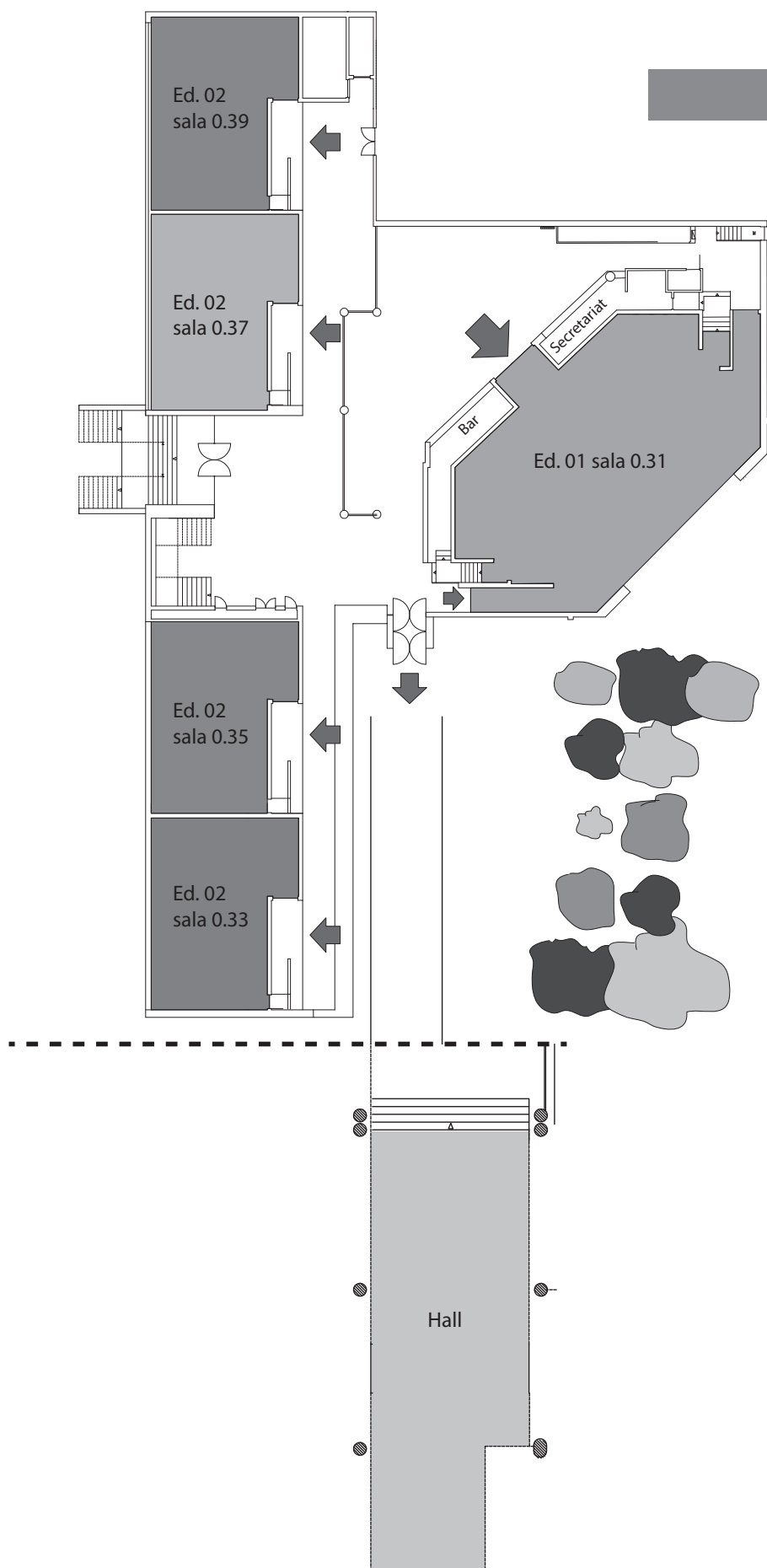



ORGANISATION

SPOSHO: Sociedade Portuguesa de Segurança e Higiene Ocupacionais
DPS - Universidade do Minho - 4800-058 Guimarães | sposho@sposho.pt | www.sposho.pt

co-organisers



institutional support

official sponsors

media partners
